

## HOW TO Install LGX® Lite V2 and PRO with Mosquito on the Voron 0.2

Difficulty **Medium**

Steps **42**

Time Required **20 to 30 min**

Sections **1**

Related Resources **[Quick Start Guide](#)**



PRODUCT PAGE

Required Tools **2mm Hex Key  
2.5mm Hex Key  
Side Cutters  
Utility Knife**

Stock Items Reused **2x M3x35  
Motor (optional)  
Hotend (optional)**



## INSTRUCTIONS GUIDE

This guide is designed to be a reference manual for how to do install LGX® Lite V2 and PRO with Mosquito on the Voron 0.2. Follow the instructions below or, if you prefer to watch a YouTube video with the same instructions, use the provided link below or the YouTube icon to the right:

<https://youtu.be/o1gK52MMq0M>

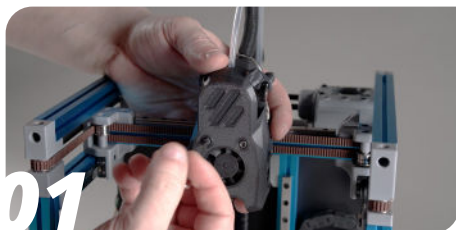
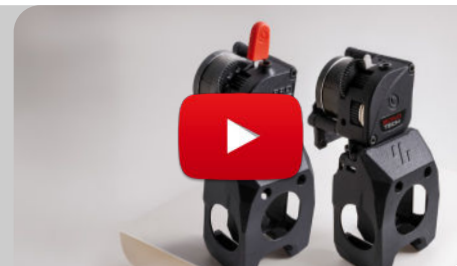

**01** Unscrew the two front screws and save them for later.



**02** Cut zip ties on the toolhead.

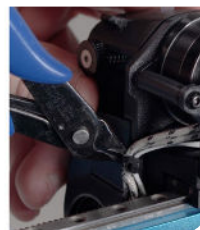

**03** Cut more zip ties on the toolhead.



**04** Cut the frame side zip tie for the wiring loom.



**05** Undo the screws holding the toolhead in place.

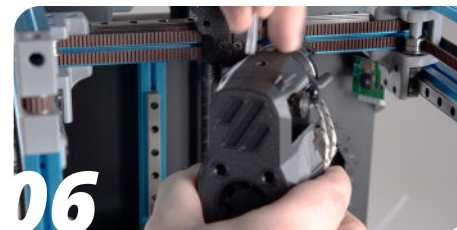

**06** Remove reverse bowden from the toolhead.

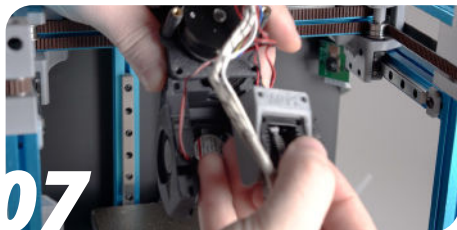

07

Remove the hotend assembly from the toolhead.

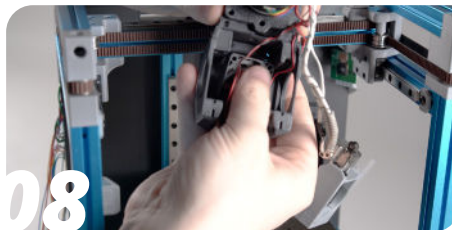

08

Remove the fans from the toolhead.

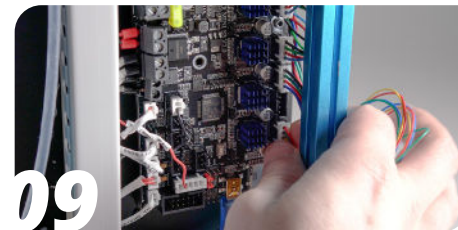

09

Unplug the extruder motor from the main board, unless you're reusing it.

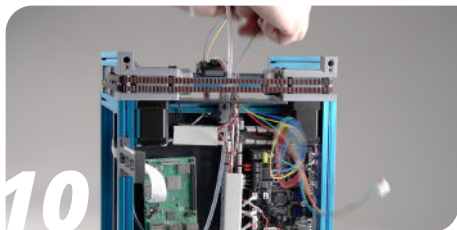

10

Undo the extruder motor wiring, unless you're reusing the motor.

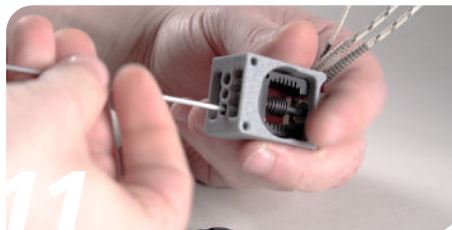

11

This optional step shows how to remove the hotend from the mount. The standard MiniUSB hotend mounts are compatible with our toolhead.

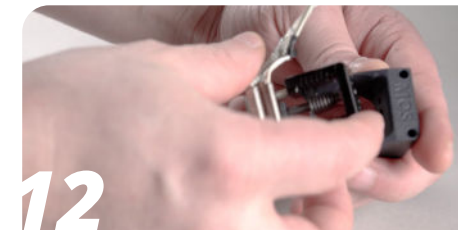

12

To mount the Mosquito or Mosquito Magnum, insert it with the heater and thermistor slots pointing the same way as the "MOS".



13

Use two M2.5x10mm included with the hotend and fasten them with a 2mm hex key.



14

Place the hotend assembly in the cowling.



15

Add the eXtruder Plate.



16

Insert the included piece of PTFE all the way until it bottoms out.



17

Place the cutting jig on top and cut in the slit using a sharp blade.

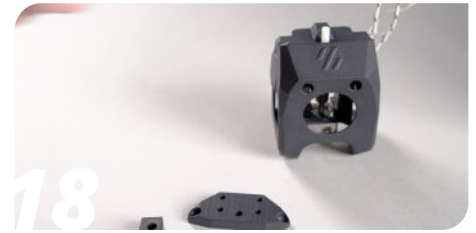

18

Remove the jig and the eXtruder Plate.

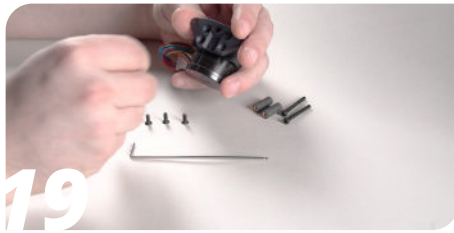

19

Add the eXtruder Plate to the bottom of the LGX Lite V2 or PRO.



20

Attach the two together using four M3x8 FHCS using a 2mm hex key.

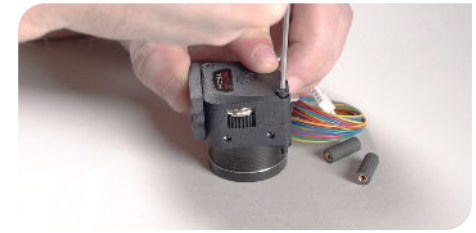

Change the extruder screws for M3x30 Low Profile one at a time.



22

Screw the standoffs on by hand.

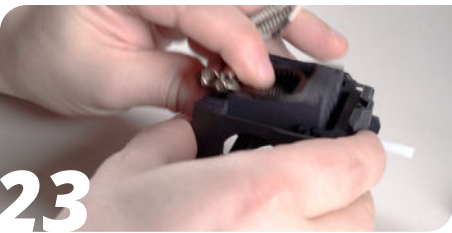

23

Remove the hotend assembly .



24

Add the axial 3010 fan or if you're coming from V0.1 you may add a spacer to your 3007 fan like shown here.





25

Add your 3010 blower fans.



26

Add the hotend mount again, being wary of the blower fan wires as to not damage them.

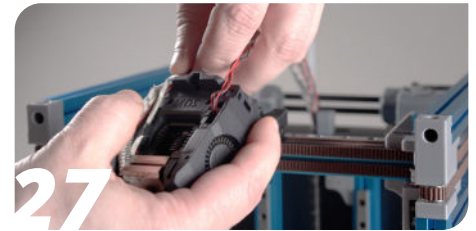

27

Add the assembly to the x-carriage, making sure not to pinch any wires.

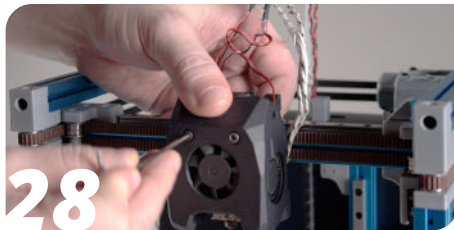

28

Add the two front screws and tighten them.

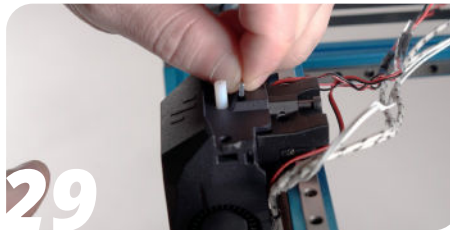

29

Add an M3 square nut from the top.

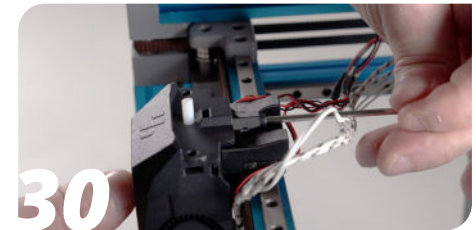

30

Add the included M3x20 BHCS from the back, through the x-carriage and tighten it with a 2.5mm hex key.

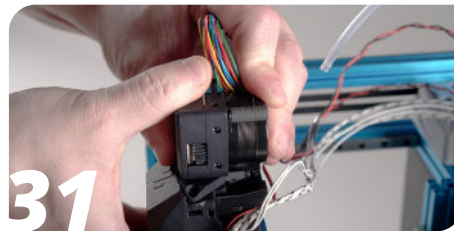

31

Add the extruder assembly.



32

Add an M3 square nut to the side pocket.

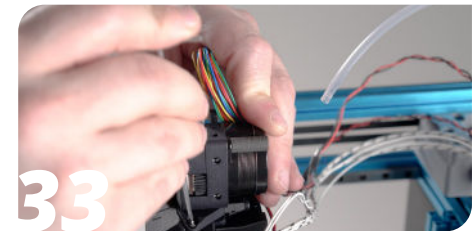

33

Add an M3x10 FHCS from the top and tighten with a 2mm hex key. Repeat for the other side.

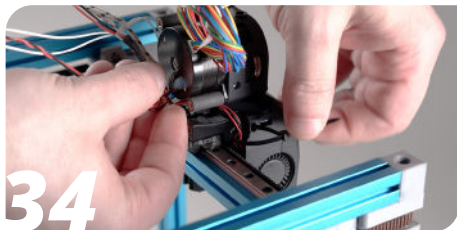

34

Add a zip tie to the side hole and secure your wiring.



35

Repeat for the other side. Don't forget to trim your zip ties ;)

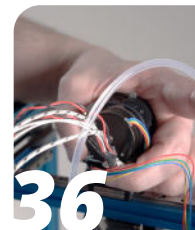

36

Bundle up your wires behind the extruder motor and add the Back Stabilizer.

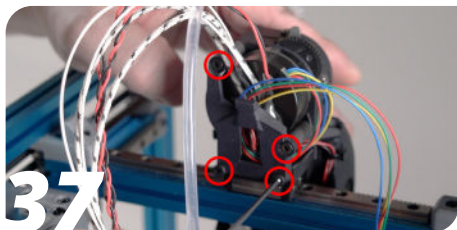
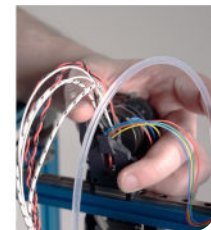

37

Fasten it using the included four M3x8 Low Profile.

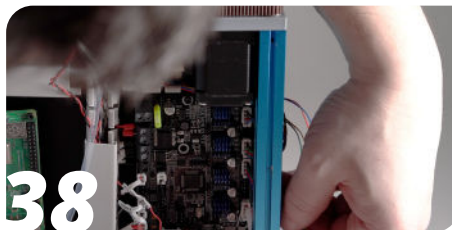

38

In case you're using a new motor, route the motor wires through the back and connect it to the extruder stepper motor port on your board.

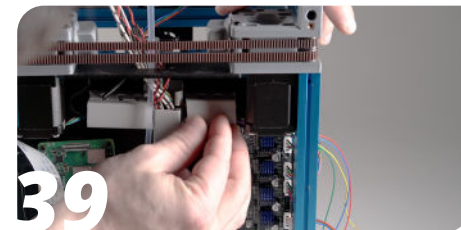

39

Adjust your wire management to suit.

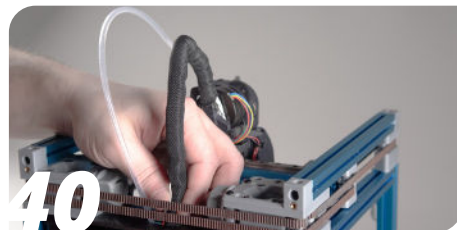

40

Add your wiring loom cover back on.

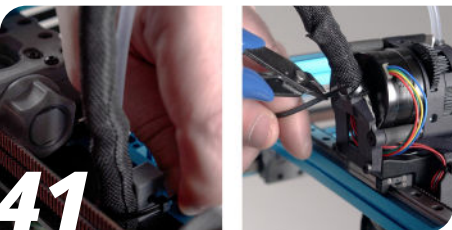

41

Secure the wiring loom with zip ties on both sides. Don't forget to trim them!



42

Insert the reverse bowden into the LGX Lite and it's done!

## TAKE GOOD CARE OF IT

Every 6 months, or sooner if you have a higher than 15h per week average usage, perform the following maintenance operations:

1. With a tooth brush and alcohol:
  - a. Clean the needle bearings
2. With a fine brush and lubricant
  - a. Lubricate the needle bearings
3. With compressed air
  - a. Blow the housing plastic parts to remove dust and dirt particles

## HOW TO GET HELP

We are available to help you with any questions or issues you may have. Simply go to our website where you can access our customer support and send us your questions or follow the provided link:

[https://www.bondtech.se/contact/#tab\\_technical-support-requests](https://www.bondtech.se/contact/#tab_technical-support-requests)

